

ESDA 402-00



Acrylic Cabinet



Our ESDA Series is suitable for storage under controlled atmosphere. This can be achieved through a nitrogen unit and / or installation of our state-of-the-art U-4001 drying unit. The cabinet is delivered without a control panel.

Proven in use around the world, the unique design of the ESDA 402 with optional drying unit U-4001 is highly energy efficient, representing a significant cost advantage for our customers

The ESDA version is produced ESD safe. The surfaces of the cabinet are not chargeable. Acrylic body 10^{-7} Ω /sq.



0 series display

Battery operated humidity measurement device (standard in cabinet)



ESDA 402-00

Standard Features

✓ Hygrometer	Hygrometer with alarm function, accuracy +/- 3%
✓ ESD safe design	Norm (IEC 61340-5-1) Acrylic body (10^{-7} Ohm/sq) Dissipative glazing (in- and outside 10^8 Ohm/sq)
✓ Lockable door	2 doors locked with key
✓ Shelves	In height adjustable chromium plated steel shelves (5 pcs)
✓ Drying unit option	Pre mounted hole for installing drying unit and N ² flow system
✓ Transport	Castors, 360° rotating wheels
✓ Power supply	Power cord 5 meter with IEC plug (when drying unit is mounted)

Benefits

✓ Recovery time after door opening	<15 minutes to below 1% (when drying unit is mounted)
✓ Highly energy efficient	Average power consumption 24 W/h (when drying unit is mounted)
✓ Options availability	Dry unit U-4001 / N ₂ (auto) Flow / SMD Reel racks, etc.
✓ Clear Polycarbonate material	Easy to look through

Technical data cabinet with drying unit U-4001

- ✓ External dimensions: (W x H x D) 574 x 1485(1690) x 517 mm
- ✓ Internal dimensions: (W x H x D) 560 x 1480 x 480 mm
- ✓ Weight: 59,1 kg
- ✓ Weight on shelf: 30 kg
- ✓ Max. loading capacity: 100 kg
- ✓ Frame: Aluminium, coated
- ✓ Body: ESD-Polycarbonate $10^7 \Omega/\text{sq}$
- ✓ Shelves (WxD): 4 pcs long, 460 x 490 mm adjustable
1 pcs short, 460 x 380 mm adjustable
- ✓ Volume: 390 L (due to volume of drying unit)
- ✓ Electric supply: 230 VAC (120 VAC optional)
- ✓ Power consumption: Average 24 W/h
- ✓ Protection class: Class 1, hard grounded
- ✓ Humidity level cabinet: $\leq 2\%$ RH depending on amount of door openings

Technical data cabinet without drying unit

- ✓ External dimensions: (W x H x D) 574 x 1485(1690) x 517 mm
- ✓ Internal dimensions: (W x H x D) 560 x 1480 x 480 mm
- ✓ Weight: 51 kg
- ✓ Weight on shelf: 30 kg
- ✓ Max. loading capacity: 100 kg
- ✓ Frame: Aluminium, coated
- ✓ Body: ESD-Polycarbonate $10^7 \Omega/\text{sq}$
- ✓ Shelves (WxD): 5 pcs long, 460 x 490 mm adjustable
- ✓ Volume: 400 L

Technical data dry-unit U-4000 series

- ✓ Control: Standalone drying unit (no control function)
- ✓ Dehumidifying Temperature: 10 – 40° C
- ✓ Electric supply: 230VAC 50Hz (120VAC 60Hz optional)
- ✓ Dimensions (L x B x H): 260 x 380 x 100 mm
- ✓ Weight: 8,1 kg
- ✓ Power consumption: 24 W/h

Technical data N² Flow

- ✓ N² connection: 8mm hose connection
- ✓ N² pressure: 1 - 6 bar
- ✓ N² standby amount: 0 - 25 L/min

Performance test

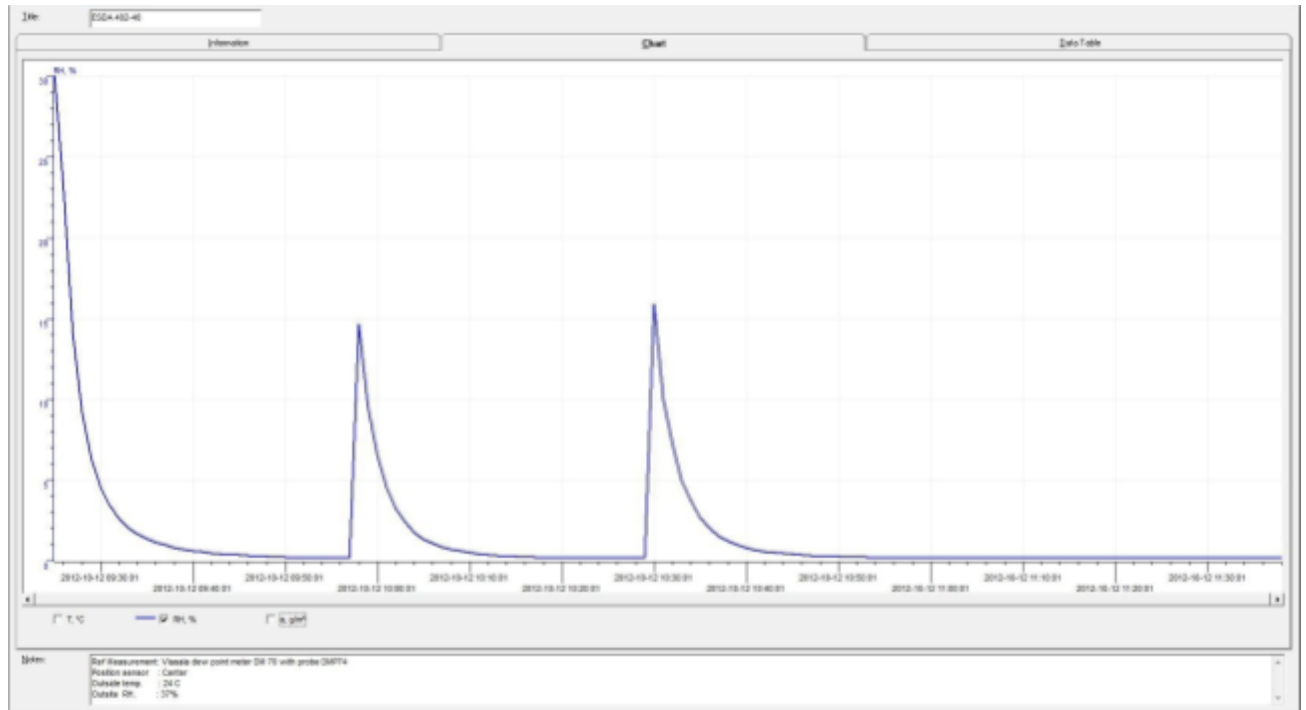

Test conditions

- ✓ Instrument: Vaisala
- ✓ Type of dew point sensor: Vaisala drycap 180M
- ✓ Accuracy of dew point sensor: $\pm 0,2^{\circ} \text{C}$ at $+ 20^{\circ} \text{C}$ ($+ 68^{\circ} \text{F}$)
- ✓ Location of sensor: In the direct surroundings of the cabinet sensor
- ✓ Ambient conditions: Hum. $50 \pm 5\% \text{ rH}$, $22^{\circ}\text{C} \pm 2^{\circ}\text{C}$, Pressure $994 \pm 20 \text{ hPa}$
- ✓ Door openings: 2 door openings, 15 sec. (average RH 0,70%)

For more detailed test results, please refer to our website.

Technical drawings

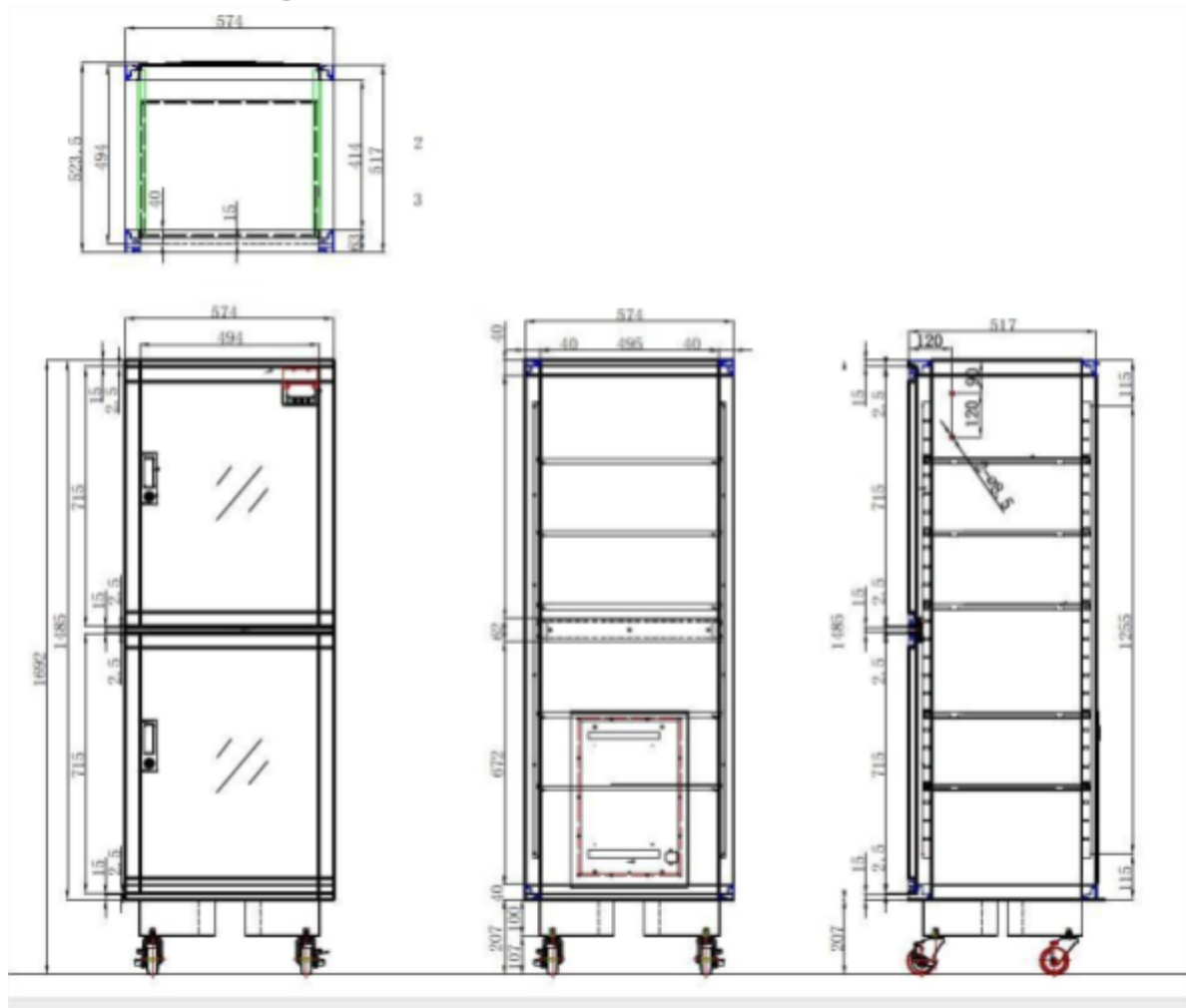

Dimensions mentioned in mm.

ESDA 402-00

Options



SMD Reel rack with reel supports
460 mm length.

Item number 20014000



Reel support
Additional reel supports for 20014000.

Item number 20014200

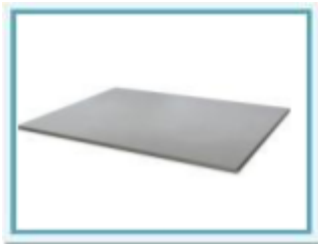

Shelf standard
For cabinets type ESDA 201 & 402

Standard:
Item number 20100021
Short, when drying unit is mounted:
Item number 30010100



N² Flow system
The N² Flow system is developed to use in combination with a Totech drying cabinet. The device is used for the quick removal of moisture in the cabinet. The drying process is realized by using nitrogen. Adjustable 10 - 100 L/min.

Item number 20010020



Trolley
For easy transportation of the cabinet, 1 meter high

Only on request

ESDA 402-00

Options



Dry unit U-4001

Item number 230V/50Hz 30021129
Item number 120V/60Hz 30021131



Rotronic datalogger set

Including HW4-E software and cable AC3006

Item number 47000580



Humidity calibrator Hygropalm 22

Precision measuring device for calibrating sensors.

Set including Hygroclip sensor, case and cable:

Item number 20001019

Hygropalm only:

Item number 20001016

V17.11